

The background is a stylized illustration of a tropical landscape. It features rolling green hills and mountains in the distance, with various tropical plants like palm trees and large-leafed shrubs in the foreground. The sky is a soft, warm orange color. The text 'ANANTARA ALORA' is centered in the upper half, enclosed in a thin orange rectangular frame. Below it, the tagline 'DISCOVER ABUNDANCE' is written in a similar orange color. At the bottom center, the name 'A. SHRIDHAR' is written in a bold, dark font, with the tagline 'BUILDING THOUGHTFULLY' underneath it in a smaller, lighter font.

ANANTARA
ALORA

DISCOVER ABUNDANCE

A. SHRIDHAR
BUILDING THOUGHTFULLY



Abundant Life

Of Peace & Elegance

The residences at Anantara Alora—spanning luxurious 3BHK & 4BHK layouts—are sanctuaries of peace and elegance. Each home is a canvas of modern aesthetics, smart home features, and premium finishes. Spacious interiors are complemented by private balconies, offering personal retreats that open up to breathtaking views. These homes are designed not just for living but for experiencing life's abundance in every moment.

21 Storeys
3 Towers
240 Abodes
12 Penthouses





Abundant Opportunities

To Dive & Unwind

Outdoors



*Urban Forest
Landscaping*



*Children's
Play Area*



*Senior Citizen
Sitouts*



Indoors



*Multi-Purpose
Lounge*



*Indoor Games
Area*



Gymnasium



Underwater



*Mini Water
Park*



*Swimming
Pool*



Jacuzzi





Abundant Care

For Huffing & Puffing

Anantara Alora embraces the love for our furry family members with a specially designed pet care room. This exclusive space features a luxurious pet spa, complete with premium pet care essentials, ensuring your beloved pets receive the pampering and care they deserve. It's a testament to our commitment to providing a holistic living experience for all residents, tail-waggers included!





Abundant Spaces

To Live & Thrive

Anantara Alora, strategically located between Science City and Shilaj Circle, boasts a prime 2 road corner plot with access to 40m and 36m roads. Surrounded by the R3 Low-Rise Zone, it offers tranquil living. The spacious 3 BHK residences feature 2 master bedrooms with attached bathrooms, private lift openings, and vestibules. Drawing, dining, and kitchen areas are bathed in natural light. All apartments have either road-facing or common plot-facing views and east-west entry. Additional amenities include 3-level basement parking, dual staircases, stretcher elevator, and courtyard-shaped balconies. Luxurious duplexes on the 21st and 22nd floors elevate living standards, ensuring opulent and sophisticated lifestyles.



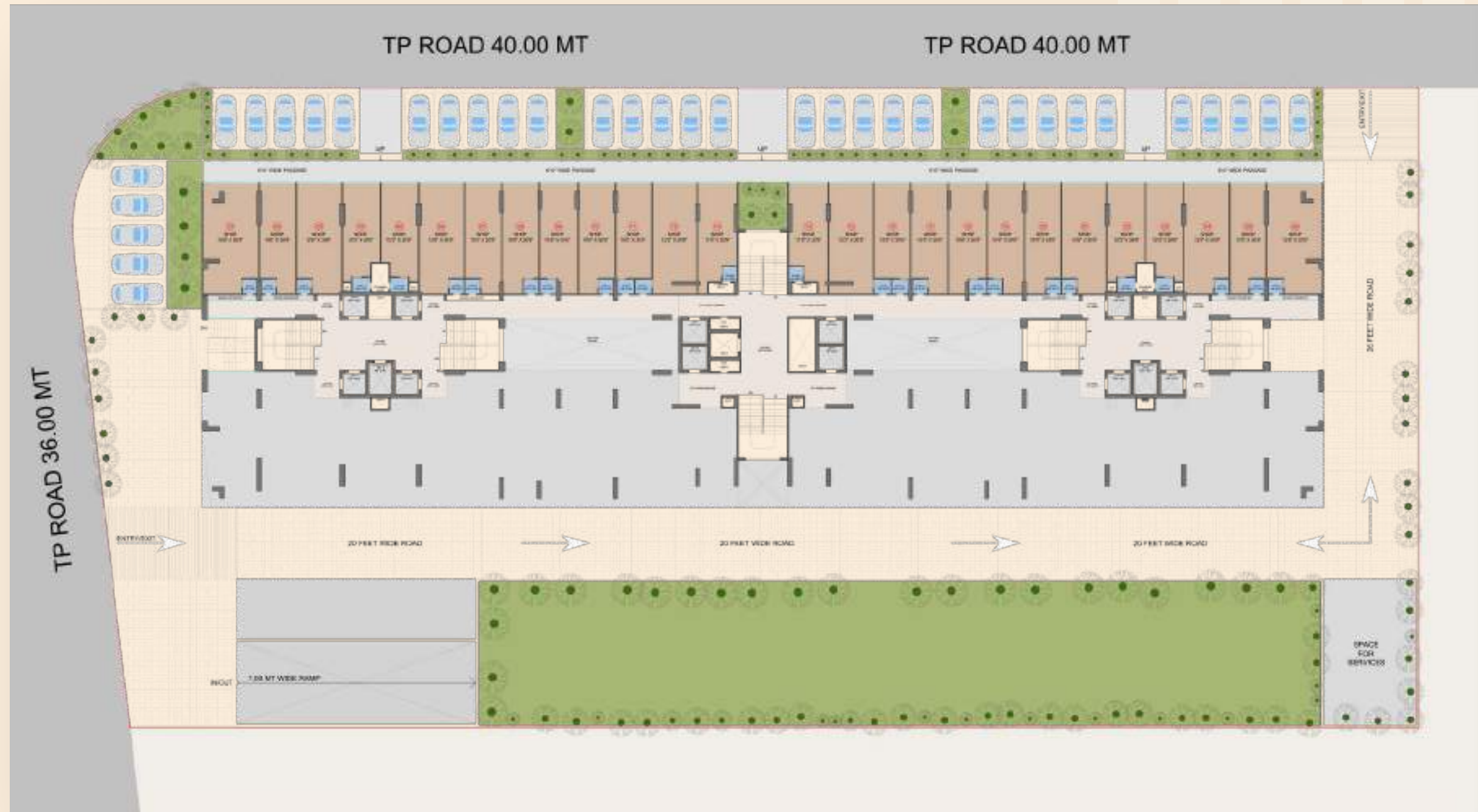

First Floor Layout



Typical Floor Layout (Type - 01) (Even Floor)

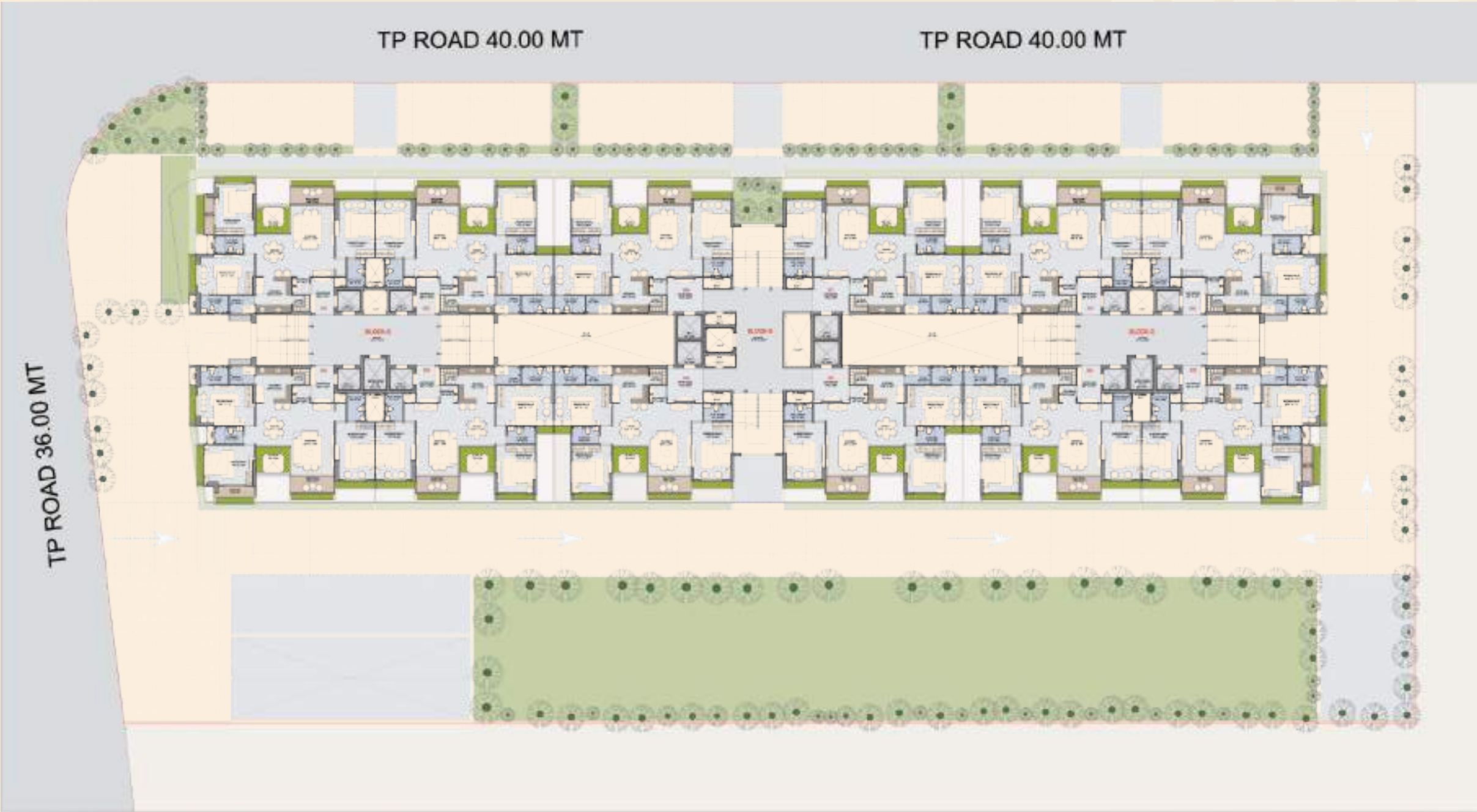

Typical Floor Layout (Type - 02) (Odd Floor)

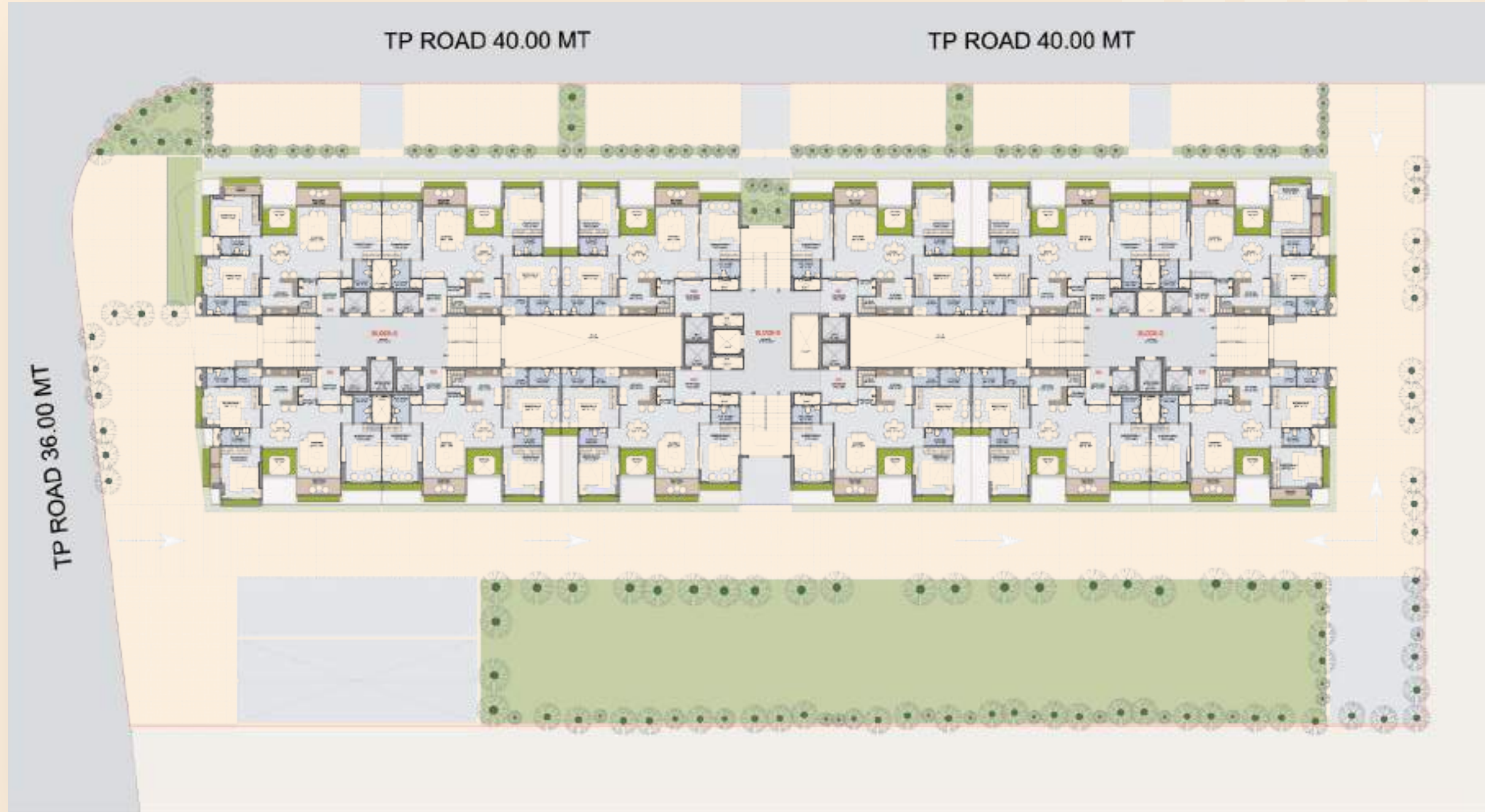

21st Floor Layout (Lower Penthouse)

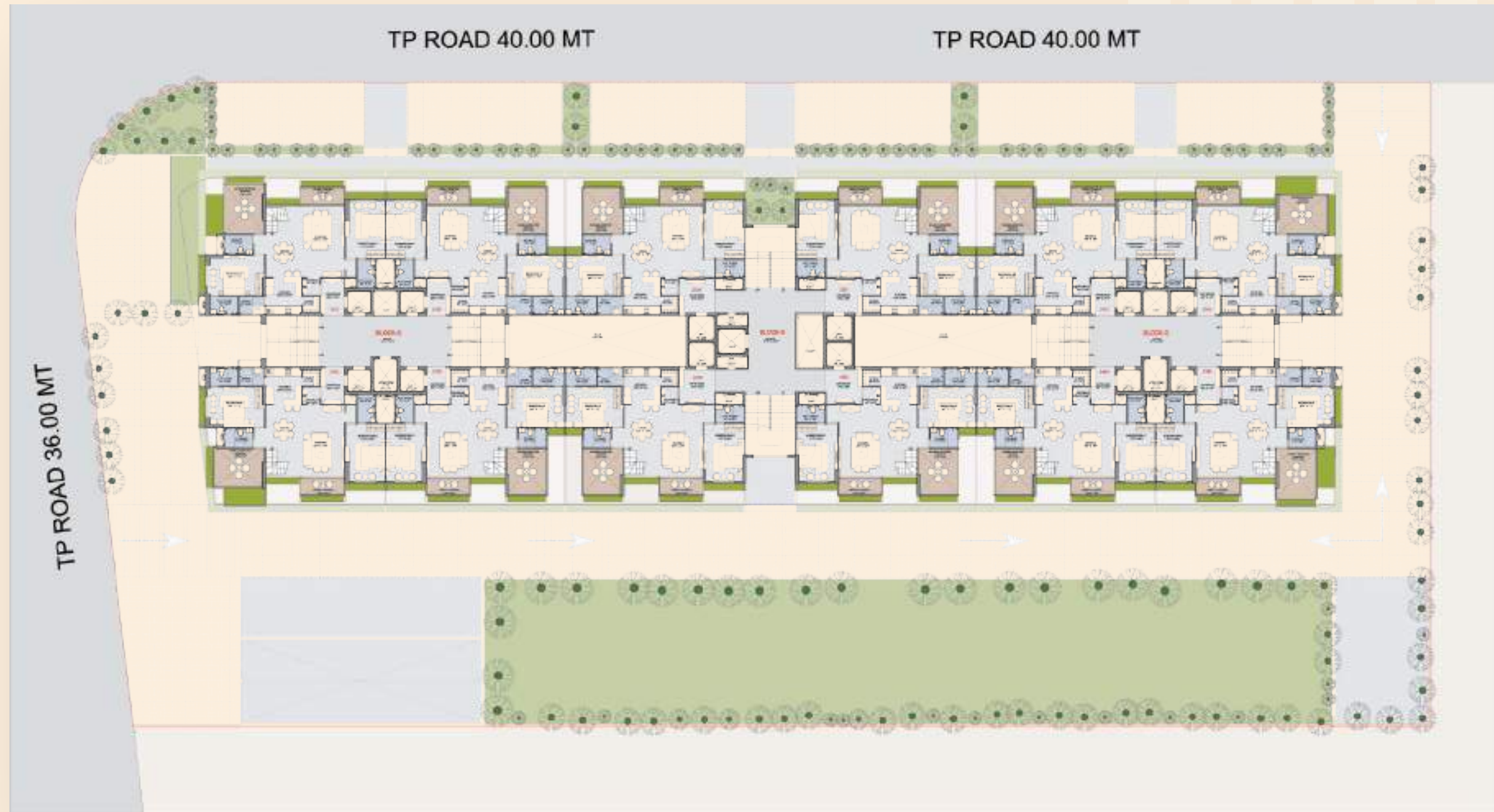

22nd Floor Layout (Upper Penthouse)

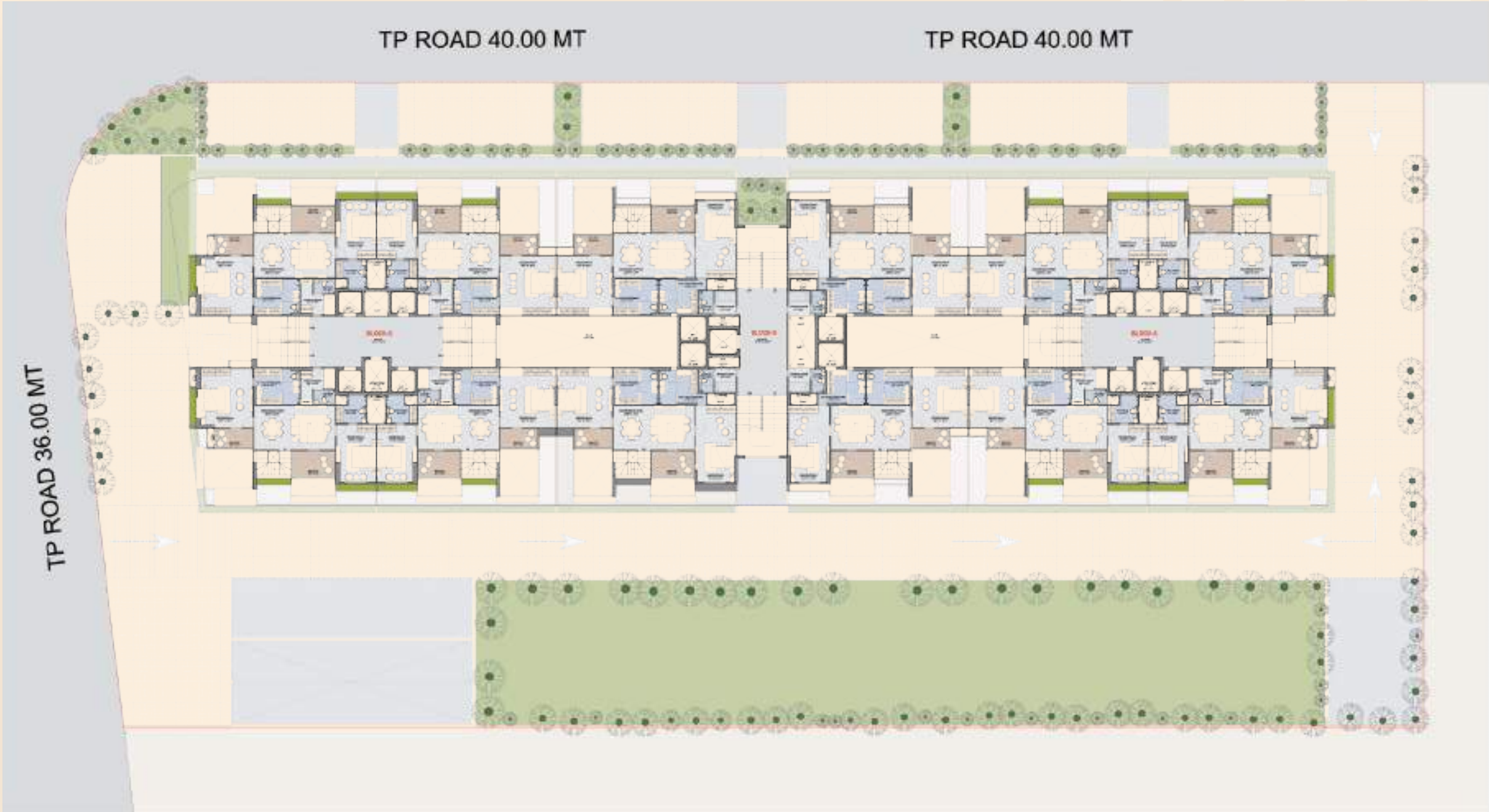



Block - A Unit - 104

3 BHK | First Floor





Block - A Unit - 103

3 BHK | First Floor



Block - B Unit - 103

3 BHK | First Floor



Block - C Unit - 103

3 BHK | First Floor





Block - A Unit - 204

3 BHK
Typical Even No. Floor





Block - A Unit - 203

3 BHK
Typical Odd No. Floor





Block - B Unit - 203

3 BHK
Typical Odd No. Floor





Block - C Unit - 203

3 BHK
Typical Odd No. Floor



Block - A Unit - 2104

4 BHK | Lower Penthouse





Block - A

Unit - 2204

4 BHK | Upper Penthouse



Block - A Unit - 2103

4 BHK | Lower Penthouse



Block - A

Unit - 2203

4 BHK | Upper Penthouse



Block - B Unit - 2103

4 BHK | Lower Penthouse



Block - B

Unit - 2203

4 BHK | Upper Penthouse





Abundant Accessibility

To Connect & Collaborate

Anantara Alora embraces the love for our furry family members with a specially designed pet care room. This exclusive space features a luxurious pet spa, complete with premium pet care essentials, ensuring your beloved pets receive the pampering and care they deserve. It's a testament to our commitment to providing a holistic living experience for all residents, tail-waggers included!

Nearby Landmarks

S.P. Ring Road	0.3 KMs
Science City & Park	3.2 KMs
Shilaj Circle	3.5 KMs
Anand Niketan Shilaj	4.0 KMs
Delhi Public School	5.0 KMs
Shivashish World School	6.8 KMs
Club Babylon	4.0 KMs
Rajpath Club	8.0 KMs
CLub O7	9.0 KMs
Zydus Hospital	3.5 KMs
HCG Hospital	3.8 KMs
CIMS Hospital	3.8 KMs





Abundant Personalization

For Today & Tomorrow

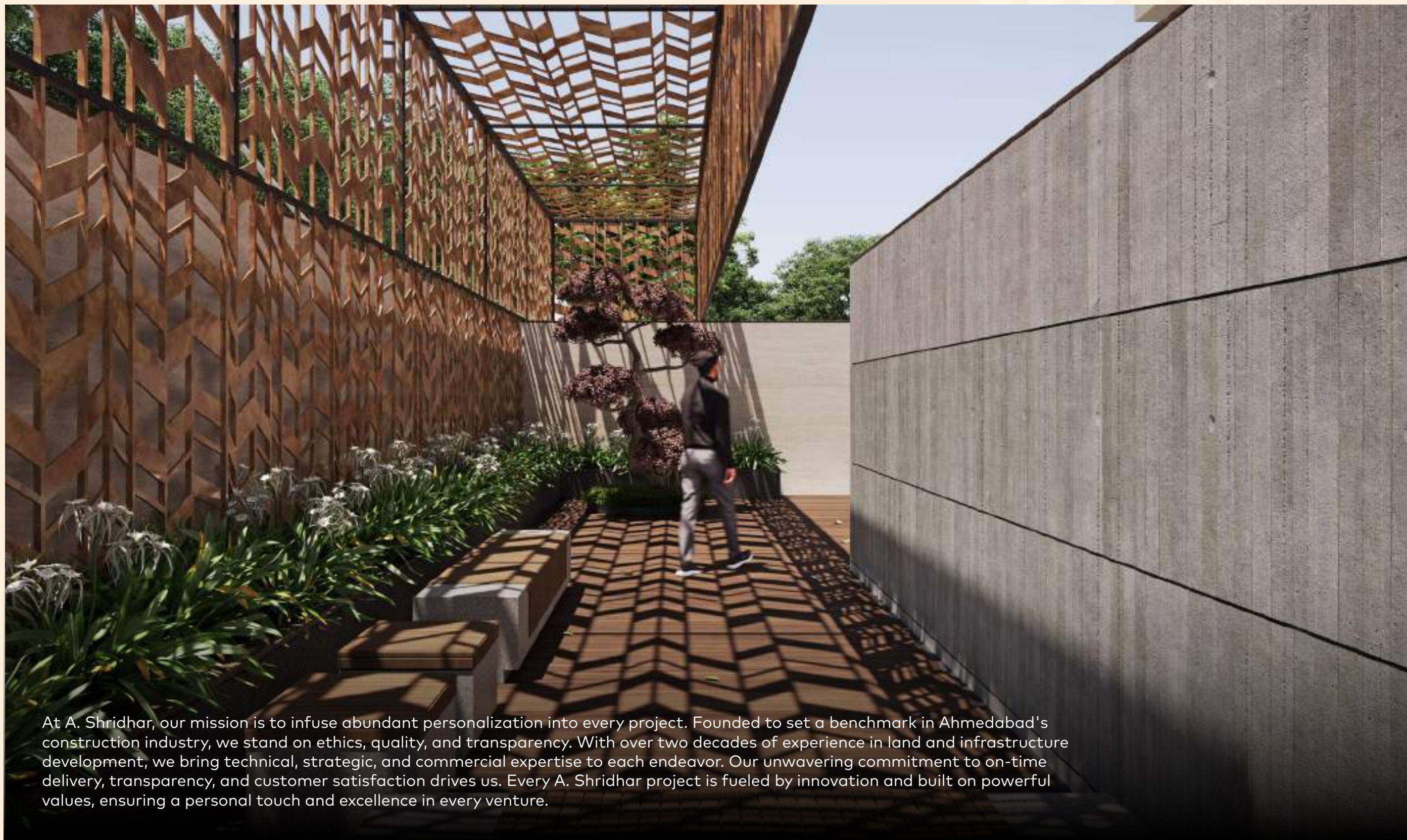

At A. Shridhar, our mission is to infuse abundant personalization into every project. Founded to set a benchmark in Ahmedabad's construction industry, we stand on ethics, quality, and transparency. With over two decades of experience in land and infrastructure development, we bring technical, strategic, and commercial expertise to each endeavor. Our unwavering commitment to on-time delivery, transparency, and customer satisfaction drives us. Every A. Shridhar project is fueled by innovation and built on powerful values, ensuring a personal touch and excellence in every venture.





ANANTARA ALORA

DEVELOPER

A. SHRIDHAR
BUILDING THOUGHTFULLY

PRINCIPAL ARCHITECT
MR. NAYAN SHAH

STUDIO EETHETICS

LANDSCAPE & INTERIOR ARCHITECT

studio nilesh kava / parita kava

MEP CONSULTANT
SHASHIN SHAH

TRANSENERGY

STRUCTURAL CONSULTANT
NIYAT PATEL

SETU
INFRASTRUCTURE

BRANDING & MARKETING

Because

A stylized illustration of a tropical landscape. In the foreground, there are large, dark green leaves with prominent veins, some showing a reddish-orange tint. The middle ground features rolling hills in shades of teal and blue, with some palm trees and other tropical plants scattered across them. The background is a soft, warm orange and yellow gradient, suggesting a sunset or sunrise. The overall style is artistic and painterly.

ANANTARA ALORA

Mandli Garba Road, Science Park
+91 8306 333 777 | www.ashridhar.com